

RAINSHOWER HEAD
COMBO



INTRODUCTION

Bring the luxury experience of a spa-like shower to your fingertips. This combination of rainfall streams and handheld precision provides customizable comfort when getting clean or practicing self-care. Get ready for an elevated showering experience with your newest favorite bathroom renovation that'll take no time to install. Let's get started.

FEATURES

- Dual Showerheads
- 3 Waterflow Options
- Adjustable Shower Arm

WHAT'S IN THE BOX

- Shower Head
- Handheld Shower Head
- Metal Hose (59.05in.)
- 3-Way Diverter
- Flow Regulator
- Teflon Tape (2x)
- Washers (6x)
- Showerhead Mount
- Extension Shower Arm
- User Guide

OVERVIEW

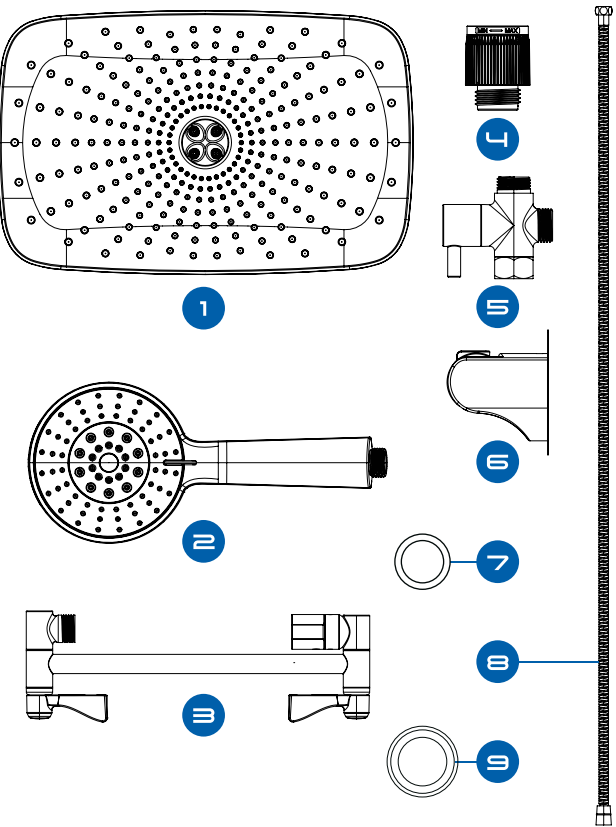

- | | |
|-------------------------|----------------------|
| 1. Shower Head | 6. Shower Head Mount |
| 2. Handheld Shower Head | 7. Washers (6x) |
| 3. Extension Shower Arm | 8. 59.05" Metal Hose |
| 4. Flow Regulator | 9. Teflon Tape (2x) |
| 5. 3-Way Diverter | |

INSTALLING THE SHOWERHEAD

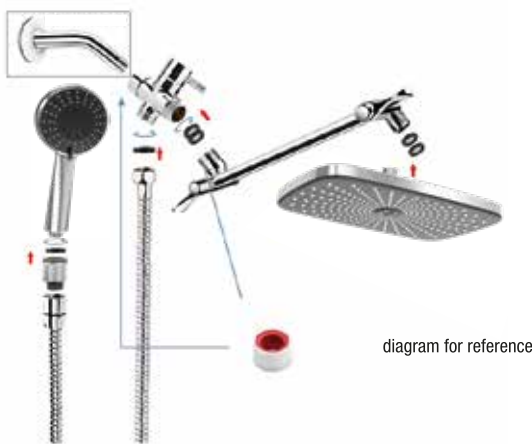

1. To install the Showerhead, use the included Teflon Tape to wrap around the shower pipe clockwise up to 2 times. Then slide one of the Washers into the opening of the 3-Way Diverter and manually screw in the diverter onto the shower water pipe clockwise.

2. When the 3-Way Diverter is secure, place a washer in-between the frontmost diverter opening to connect the extension arm. Screw the arm into place by rotating it clockwise.
a. Using the provided diagram, make sure the extension arm pieces are connecting to the correct ends during installation.

- continued on the back

INSTALLING THE SHOWERHEAD

3. Screw the Rainfall Showerhead into the other end of the extension arm, placing two washers in between the connecting points to prevent leakage.
4. To attach and install the Handheld Showerhead, place a Washer between the bottom diverter opening and the smaller end of the Shower Hose and screw them together clockwise. Then, on the other end of the hose, connect the Handheld Showerhead, a Washer, the Flow Regulator, and the other end of the Shower Hose together as shown in the diagram.
5. To install the Handheld Shower Mount, ensure the intended surface area is dry and free of dirt or debris. Check the mount's positioning to ensure it is facing upright to hold the showerhead in place. Once the positioning is right, remove the adhesive sticker and press the bracket onto the shower wall firmly. Leave the bracket on the wall for 24 hours without putting the shower head on it before use.

Note: It's important to utilize the washers at the designated points of connection to prevent leakage.

USING THE SHOWERHEAD COMBO

1. To adjust the positioning of the Rainfall Showerhead, use the front or back levers on the extension arm until the head is in the ideal position.
2. To divert the water output between the Showerheads, toggle the 3-Way Diverter to reach the desired output:
a. Rainfall: Only the Rainfall Showerhead sprays.
b. Handheld: Only the Handheld Showerhead sprays.
c. Dual Spray: Both the Handheld and Rainfall heads spray.
3. To adjust the Handheld Showerhead's spray settings, toggle the Showerhead's knob clockwise or counter-clockwise to the preferred setting until you hear a click sound. The spray settings are:
a. Rain Massage
b. Pulsating Massage
c. Power Rain
d. Rain Mist
e. Power Mist

CARE AND MAINTENANCE

- To clean the showerhead and all accessories, wipe the products with a soft cloth and mild soap.
- If you notice a decrease in the Showerhead's waterflow, run the water and prod the hole openings to release sediments and debris in the showerhead. If the problem persists then remove the showerhead & clean the internal washer with a small cleaning brush.

PRODUCT SPECIFICATIONS

Product size:
• Showerhead: 12" x4"
• Extension Arm: 9.72"
• Handheld Shower Head: 10.16"
• Shower Hose: 59.05'
• Weight: About 4 lbs

WARNINGS & SAFETY INFORMATION

Before using this product, please read the following safety precautions carefully, and keep this user guide for future reference.

- Always put the Handheld Showerhead back in place when not in use, leaving it hanging can lead it to spraying the bathroom area when turned on due to powerful waterflow.
- Do not drop the Handheld Showerhead, as doing so can risk personal injury to the user, damage to the product, or damage to the immediate bathing area where it has been installed.

CUSTOMER SUPPORT

If you have any questions about using this product, we are here to help! Call or email us, and an experienced customer support representative will be happy to assist you:

1-855-GO-TZUMI or **support@tzumi.com**.

tzumi®
live awesome.



Rainshower Head Combo. Item No. 30242. Distributed by tzumi® Inc., NY, NY, 10016. ©Copyright 2025 tzumi Inc. All Rights Reserved. Made in China. All other trademarks and trade names are the property of their respective owners. All pictures shown are for illustration purposes only. Actual product may vary due to product enhancement. Subject to change without prior notice.